



COORDINATE SCHEDULE				
MARK	M. G. A. COORDINATES	CLASS	P.U.	METHOD
PM 56731	472 507.120 6 500 829.796	A	0.02	FROM SCIMS FOUND
PM 56732	472 576.860 6 500 614.751	B	0.02	FROM SCIMS FOUND
PM 79433	473 356.216 6 500 493.975	B	0.02	FROM SCIMS FOUND
DATE OF SCIMS COORDINATES: 21-09-2022 MGA ZONE: 56				
MGA DATUM: GDA 2020 COMBINED SCALE FACTOR 0.999603				

CONNECTIONS BETWEEN SSM'S		
FROM	TO	DISTANCE
PM 56731	PM 74933	121°26'59" 643.904 (MGA GROUND)
PM 56731	PM 74933	121°26'59" 643.884 (SURVEY)
PM 56731	PM 56732	226°57'24" 315.188 (MGA GROUND)
PM 56731	PM 56732	226°57'33" 315.193 (SURVEY)
PM 56732	PM 56732	278°48'32" 788.972 (MGA GROUND)
PM 56732	PM 56732	278°48'33" 788.976 (SURVEY)

THE COMPILED DIMENSIONS FOR LOT 2 HAVE BEEN ADOPTED FROM DP 1115744.

PM 74933 FD

NOT TO SCALE

PM 56731 FD

PM 56732 FD

PM 56733 FD

PM 56734 FD

PM 56735 FD

PM 56736 FD

PM 56737 FD

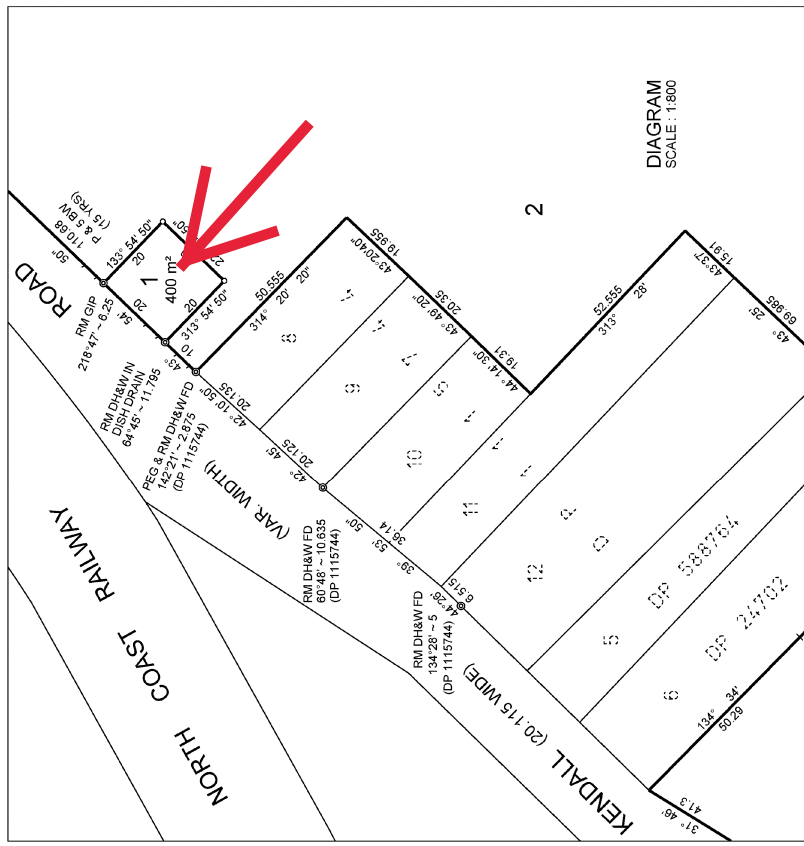

DIAGRAM
SCALE: 1:800

SCHEDULE OF SHORT LINES	
No.	BEARING AND DISTANCE
1	43°37' 15.91
2	44°14'30" 19.31
3	43°49'20" 20.35
4	43°20'40" 19.955

PLAN OF ACQUISITION FOR SEWERAGE PURPOSES
WITHIN LOT 7 DP 1115744.

SURVEYOR
Name: DANIEL JOHN BAKER
Date: 26/9/2022
Reference: 7864

LGA: PORT MACQUARIE-HASTINGS
Locality: KENDALL
Reduction Ratio 1: 2000
Lengths are in metres.

REGISTERED
24/10/2022

DP1288625